

# FOR SALE

## RESIDENTIAL - CONDOMINIUM 635SQFT (59SQM) / CALL FOR PRICE!

+65 9748 0556



2 - Bedroom

TYPE 2BR-C1  
59 sqm / 635 sqft  
#02-09 to #09-09 (21 STIRLING ROAD)  
#02-12 to #09-12 (23 STIRLING ROAD)

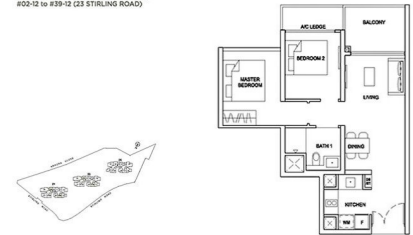

### RESIDENTIAL - CONDOMINIUM

21 STIRLING ROAD, ALEXANDRA, COMMONWEALTH,  
SINGAPORE 148960

- LISTING ID: SGLD81363325
- TENURE: LEASEHOLD 99
- TITLE: N/A
- SIZE BUILT-UP: 635SQFT (59SQM)
- SIZE LAND: 5.216AC (2.111HA)
- NO. OF FLOORS: 40
- FLOOR/LEVEL: N/A - MIDDLE FLOOR
- BED ROOMS: 2
- BATH ROOMS: 1
- MAIDS ROOMS: N/A
- PARKING SPACES: N/A
- LAYOUT TYPE: OTHER
- FACING: N/A
- VIEWING: N/A
- SELLING PRICE: **CALL FOR PRICE!**
- COMPLETION YEAR: 2022
- CONDITION: ORIGINAL CONDITION
- FURNISHING: PARTIALLY FURNISHED
- LISTING DATE: JUN 24, 2019

### STIRLING RESIDENCES

Condominium for Sale: Partially furnished. 2 bedroom, 1 bathroom. Completed in 2022, this unit is in original condition. Tenure: Leasehold 99 Located in Singapore's district D03 near Alexandra, Commonwealth in the area Central South (Central region).

### EXTERIOR FACILITIES

- 24 Hours Security
- Covered Car Park
- Clubhouse
- Function Room

VISIT THIS PROPERTY AT: <https://www.shaleneproperty.com/property/SGLD81363325>



### SHALENE NG - HUTTONS ASIA PTE LTD

3 Bishan Place #05-01 CPF Bishan Building  
D20, 579838, Singapore

+65 9748 0556  
WhatsApp Me

shalene.ng@outlook.com

L3008899K  
R048558Z

<https://www.shaleneproperty.com>



Scan QR Code

**Huttons**® Call for Viewing  
The Agency of Choice +65-97480556